

**STRAIGHT BULKHEAD JACK CLAMP TYPE  
REAR MOUNT - CABLE 1/4" HELICAL**

**R185.315.200**  
**SERIES 7-16**

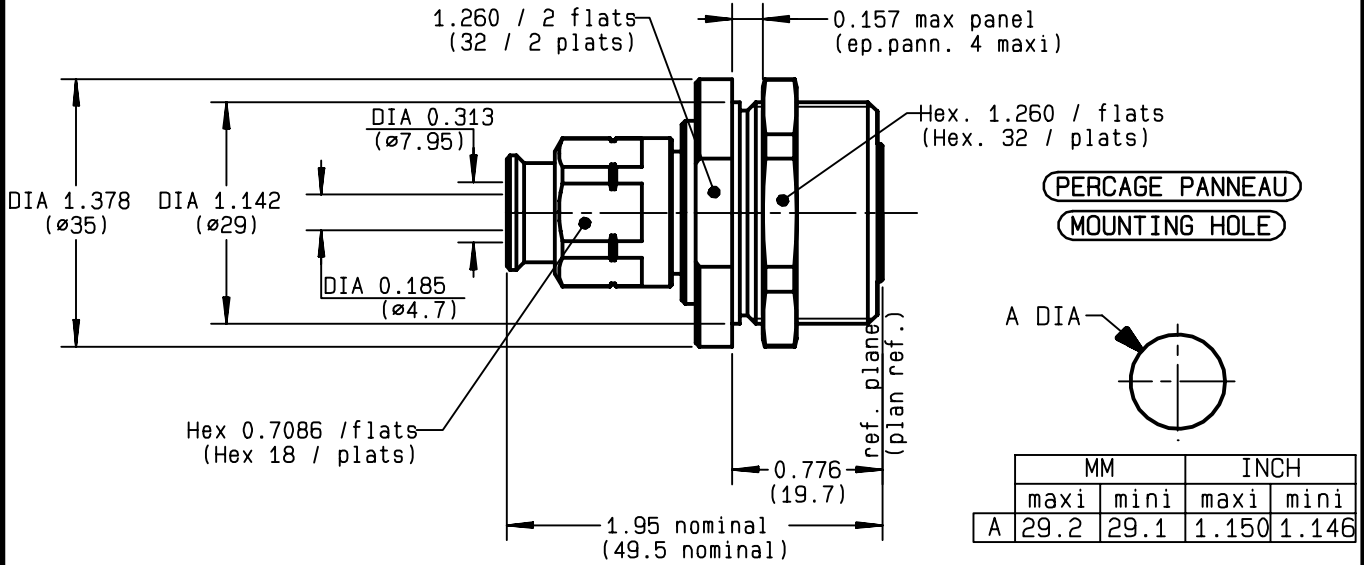

NOMINAL IMPEDANCE	<b>50</b>	$\Omega$
FREQUENCY RANGE	<b>0-7.5</b>	GHz
TEMPERATURE RATING	<b>-55/+155</b>	$^{\circ}\text{C}$
V.S.W.R	<b>1.20</b> +	x F(GHz)Maxi
RF INSERTION LOSS	<b>0.05</b>	$\sqrt{F}$ (GHz) dB Maxi
VOLTAGE RATING	<b>1400</b>	Veff Maxi
DIELECTRIC WITHSTANDING VOLTAGE	<b>2700</b>	Veff Mini
INSULATION RESISTANCE	<b>10000</b>	M $\Omega$ Mini
HERMETIC SEAL	<b>NA</b>	Atm.cm <sup>3</sup> /s
LEAKAGE (pressurized only)	<b>IP 67</b>	
MECHANICAL DURABILITY	<b>500</b>	Cycles
WEIGHT		gr
SPECIFICATION		

CABLES : **FSJ1RN-50A - 1/4"**  
**HCF 1/4" Cu2Y AlCu**

OTHERS CHARACTERISTICS

**ROS : 1.10 a 3 GHz**

CABLE RETENTION **200** N Mini

CENTER CONTACT RETENTION

Axial force - mating end **200** N Mini

Axial force - opposite end **100** N Mini

Torque **2** cm.N Mini

RECOMMENDED TORQUES

Mating **NA** cm.N

Panel nut **3000** cm.N

Clamp nut **950** cm.N

CONNECTOR PARTS	MATERIALS	FINISH	(all values are given in micrometers)
BODY	BRASS	BBR 0.5 OVER SILVER 3	
OUTER CONTACT	BRASS	SILVER 5 OVER COPPER 0.5	
CENTER CONTACT	BERYLLIUM COPPER	SILVER 5 OVER COPPER 0.5	
INSULATOR	PTFE	-	
GASKET	SILICONE RUBBER	-	
OTHERS PIECES	BRASS	BBR 2	

ISSUE	CREATION DATE	FILE PART-NUMBER
<b>9944B00</b>	<b>26/05/1994</b>	<b>EPC94-10</b>



GAUTIER

The information given here is subject to change without notice. Design changes may be in order to improve the product .

*Connect to the future*



**R185.315.200**

ISSUE **9944B00** SERIES **7-16**

HEATSHRINK SLEEVE

BRAID CLAMP NUT

GASKET

BODY

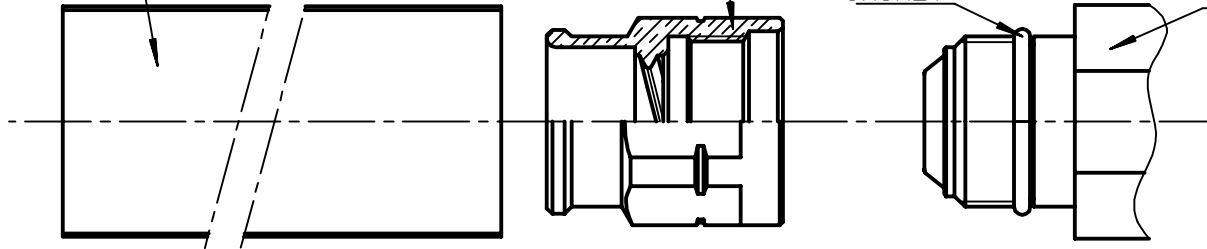

- ① - Strip the cable.  
Stripping tool R282.010.030  
- Do not damage the outer conductor.  
- Deburr cable inner conductor.

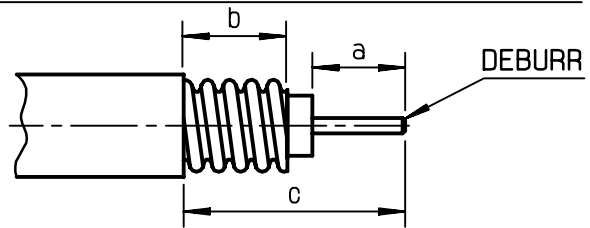

Stripping	a	b	c	d	e
inch	0.217	0.197	0.453	0	0
mm	5.5	5	11.5		

- ② - Slide the heatshrink sleeve onto the cable.  
- Screw manually the braid clamp nut onto cable outer conductor until stop.

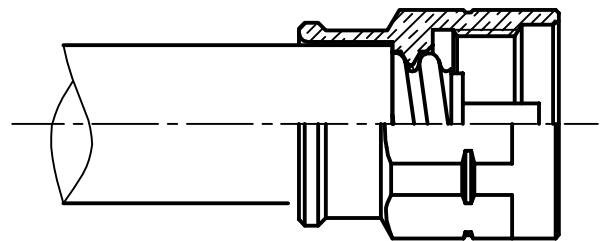

- ③ - Screw the connector onto the assembly.  
**WARNING :** Screw the connector on the braid clamp nut turning left (lefthand thread) so that the copper outer conductor is being squeezed.  
Torque wrench R282.303.220  
Recommended coupling torque: 84.07 in.lb  
950 Ncm

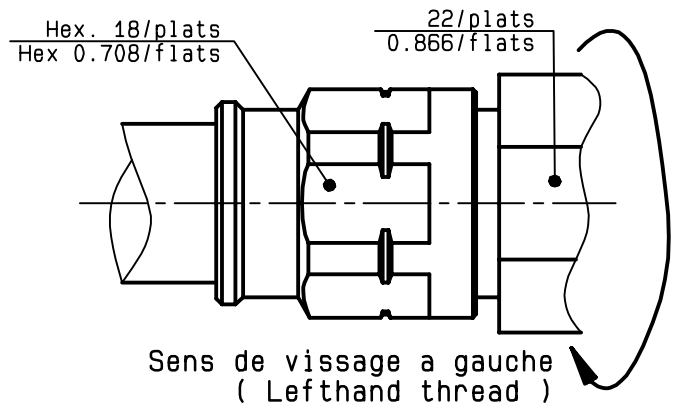

- ④ - Shrink the heatshrink sleeve.

Shrink the heatshrink sleeve

